

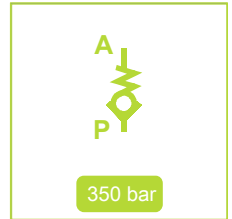

Advantages:

- ✓ 3 thread shapes
- ✓ Simple counter contour
- ✓ Low cracking pressure
- ✓ High temperatures possible
- ✓ Complete made from stainless steel
- ✓ Repeatedly to assemble



Details

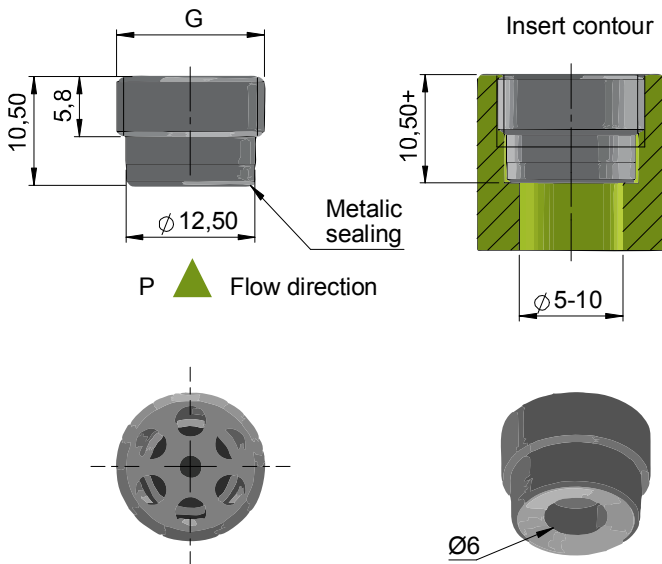

Key figures

Cracking pressure	0,6 bar
Max. flow rate hydraulic	28 l/min
Temperature range	-40°C bis +250°C
Max. working pressure	350 bar
Material-Valve	316L
Diameter	ND 6

Einschraubwerkzeug

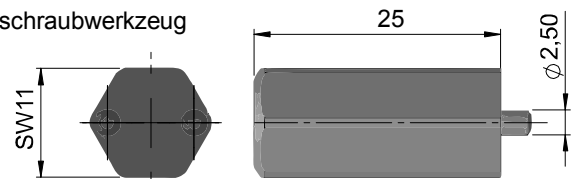

Part number	G (Thread)	Mounting tool
INRV06-001	UNF 9/16-18	INRV06-T
INRV06-002	G3/8	INRV06-T
INRV06-003	M14x1,5	INRV06-T

Notes

Pressure drop Hydraulic oil

Δp -characteristic

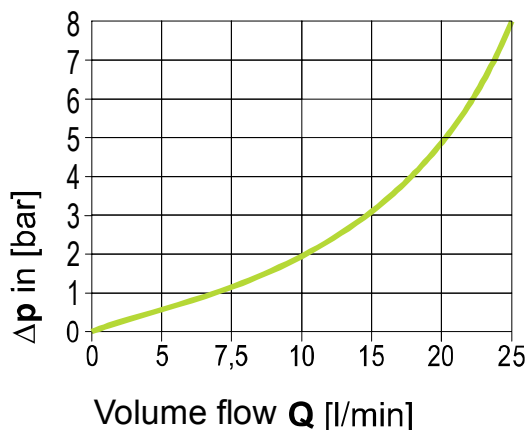

Generally:

These valves are spring-loaded plate valves, which get metallic seals, only. For this reason, high operating temperatures can be achieved.

The maximum permissible flow rates must not be exceeded.

The maximum pressure must not be exceeded even with pressure peaks.

The valves blocks in the screw-in direction (A to P). In the opposite direction, they open at a pressure of 0.6 bar.

Contact

iNOSOL GmbH
Frankfurter Str. 18
35315 Homberg/Ohm (Germany)

web: www.inosol.solutions
email: info@inosol.solutions
tel.: (+49) 6633 / 368 95 25